

## Releasing the bellows (door boot) from the front panel:

The front of the bellows is installed over the lip of the door opening in the front panel and held in place by a spring loaded wire loop.

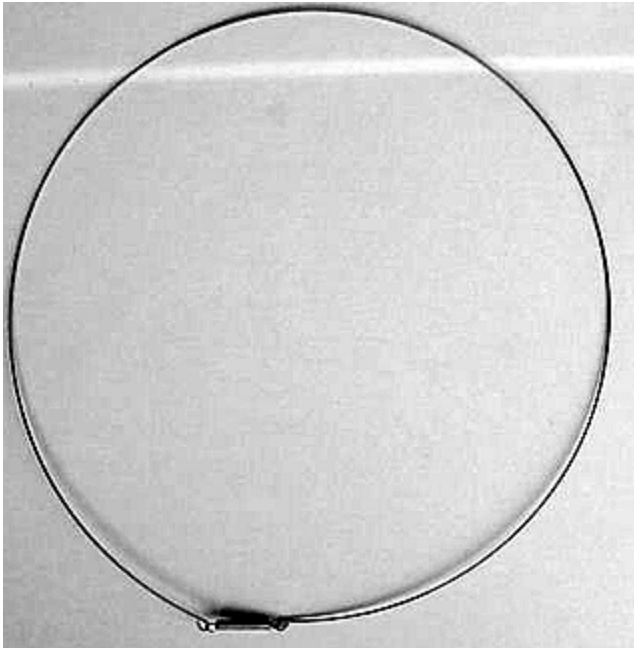

1. Open the loading door.
2. Using needle nose pliers, start where the spring and wire are connected at the bottom of the bellows and pull the wire out of the groove of the bellows.



3. Pull the bellows off of the lip of the front panel.



## Removing the door safety switch:

1. Disconnect the washer from the electrical supply.
2. Release the bellows from the front panel.
3. Remove the (2) screws securing the switch assembly to the front panel.

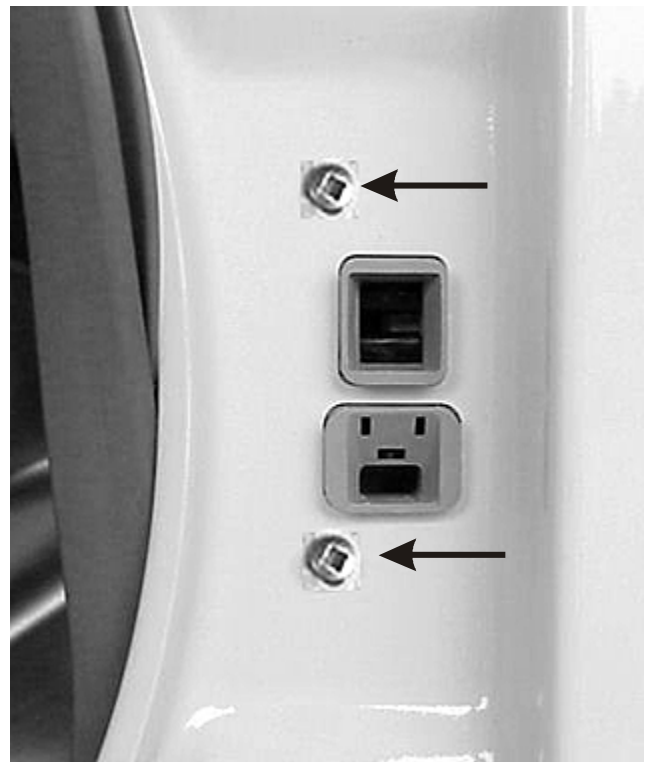

4. Pull the switch assembly into the door opening and unplug the electrical connectors.

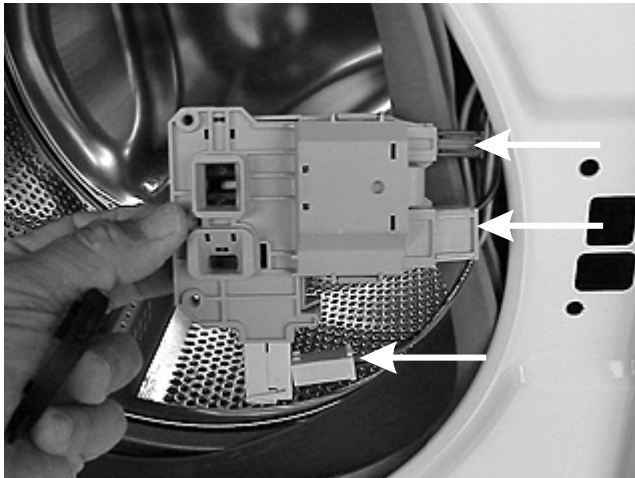

3. Remove the (3) screws behind the detergent drawer panel.



### Releasing the console:

1. Disconnect the washer from the electrical supply, remove the top panel and detergent drawer.
2. Remove the (2) screws, one on each end, holding the console to the top of the side panels.



4. Lift the (3) tabs to release the top of console from the mounting plate.



5. Roll the console forward, while lifting up to release the bottom tabs from the front panel.

